

<< Inductive Sensor

Metal Barrel-M12



Description:

Brass nickel-plated, threaded barrel, DC 2-wire output, IP67 protection class, LED indicator.

Technical Data:

Type	Rated Operating Distance S_n	Mounting	Output	Voltage Range U_B	Rated Current	Switching Frequency	Ambient Temperature	Connection	Fig
Fi2-M12-OD6L	2mm	Flush	DC NO	10...30VDC	≤100mA	1000Hz	-25...70°C	2m cable	Fig.1
Fi2-M12-CD6L	2mm	Flush	DC NC	10...30VDC	≤100mA	1000Hz	-25...70°C	2m cable	Fig.1
Ni4-M12-OD6L	4mm	Non-flush	DC NO	10...30VDC	≤100mA	800Hz	-25...70°C	2m cable	Fig.2
Ni4-M12-CD6L	4mm	Non-flush	DC NC	10...30VDC	≤100mA	800Hz	-25...70°C	2m cable	Fig.2
Ni5-M12-OD6L	5mm	Non-flush	DC NO	10...30VDC	≤100mA	800Hz	-25...70°C	2m cable	Fig.2
Ni5-M12-CD6L	5mm	Non-flush	DC NC	10...30VDC	≤100mA	800Hz	-25...70°C	2m cable	Fig.2
Fi2-M12-OD6L-Q12	2mm	Flush	DC NO	10...30VDC	≤100mA	1000Hz	-25...70°C	M12 Connector	Fig.3
Fi2-M12-CD6L-Q12	2mm	Flush	DC NC	10...30VDC	≤100mA	1000Hz	-25...70°C	M12 Connector	Fig.3
Ni4-M12-OD6L-Q12	4mm	Non-flush	DC NO	10...30VDC	≤100mA	800Hz	-25...70°C	M12 Connector	Fig.4
Ni4-M12-CD6L-Q12	4mm	Non-flush	DC NC	10...30VDC	≤100mA	800Hz	-25...70°C	M12 Connector	Fig.4
Ni5-M12-OD6L-Q12	5mm	Non-flush	DC NO	10...30VDC	≤100mA	800Hz	-25...70°C	M12 Connector	Fig.4
Ni5-M12-CD6L-Q12	5mm	Non-flush	DC NC	10...30VDC	≤100mA	800Hz	-25...70°C	M12 Connector	Fig.4

Dimensions:

Fig.1

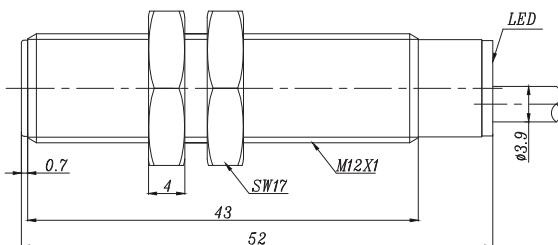

Fig.2

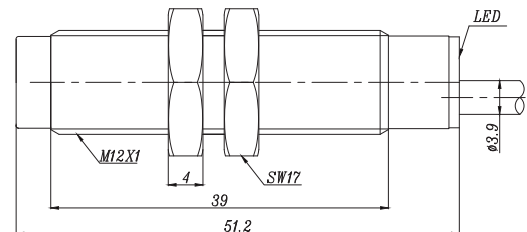

Fig.3

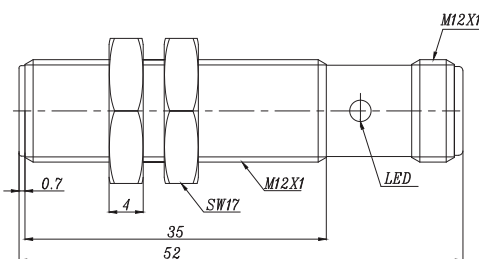
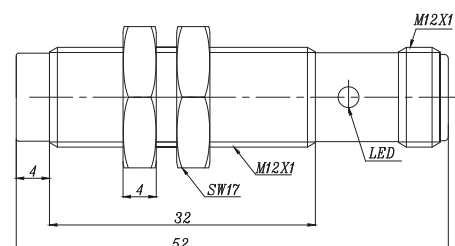

Fig.4



Metal Barrel-M12



Description:

Brass nickel-plated, threaded barrel, DC 3-wire output, IP67 protection class, LED indicator.

Technical Data:

Type	Rated Operating Distance S_n	Mounting	Output	Voltage Range U_B	Rated Current	Switching Frequency	Ambient Temperature	Connection	Fig
Fi2-M12-OP6L	2mm	Flush	PNP NO	10...30VDC	$\leq 200\text{mA}$	1000Hz	-25...70°C	2m cable	Fig.1
Fi2-M12-ON6L	2mm	Flush	NPN NO	10...30VDC	$\leq 200\text{mA}$	1000Hz	-25...70°C	2m cable	Fig.1
Fi2-M12-CP6L	2mm	Flush	PNP NC	10...30VDC	$\leq 200\text{mA}$	1000Hz	-25...70°C	2m cable	Fig.1
Fi2-M12-CN6L	2mm	Flush	NPN NC	10...30VDC	$\leq 200\text{mA}$	1000Hz	-25...70°C	2m cable	Fig.1
Ni4-M12-OP6L	4mm	Non-flush	PNP NO	10...30VDC	$\leq 200\text{mA}$	800Hz	-25...70°C	2m cable	Fig.2
Ni4-M12-ON6L	4mm	Non-flush	NPN NO	10...30VDC	$\leq 200\text{mA}$	800Hz	-25...70°C	2m cable	Fig.2
Ni4-M12-CP6L	4mm	Non-flush	PNP NC	10...30VDC	$\leq 200\text{mA}$	800Hz	-25...70°C	2m cable	Fig.2
Ni4-M12-CN6L	4mm	Non-flush	NPN NC	10...30VDC	$\leq 200\text{mA}$	800Hz	-25...70°C	2m cable	Fig.2
Ni5-M12-OP6L	5mm	Non-flush	PNP NO	10...30VDC	$\leq 200\text{mA}$	800Hz	-25...70°C	2m cable	Fig.2
Ni5-M12-ON6L	5mm	Non-flush	NPN NO	10...30VDC	$\leq 200\text{mA}$	800Hz	-25...70°C	2m cable	Fig.2
Ni5-M12-CP6L	5mm	Non-flush	PNP NC	10...30VDC	$\leq 200\text{mA}$	800Hz	-25...70°C	2m cable	Fig.2
Ni5-M12-CN6L	5mm	Non-flush	NPN NC	10...30VDC	$\leq 200\text{mA}$	800Hz	-25...70°C	2m cable	Fig.2

Dimensions:

Fig.1

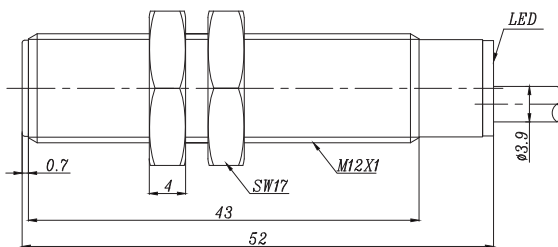
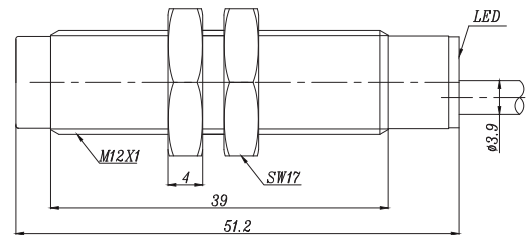

Fig.2



<< Inductive Sensor

Metal Barrel-M12



Description:

Brass nickel-plated, threaded barrel, DC 3-wire output, IP67 protection class, LED indicator.

Technical Data:

Type	Rated Operating Distance S_n	Mounting	Output	Voltage Range U_B	Rated Current	Switching Frequency	Ambient Temperature	Connection	Fig
Fi2-M12-OP6L-Q12	2mm	Flush	PNP NO	10...30VDC	≤200mA	1000Hz	-25...70°C	M12 Connector	Fig.1
Fi2-M12-ON6L-Q12	2mm	Flush	NPN NO	10...30VDC	≤200mA	1000Hz	-25...70°C	M12 Connector	Fig.1
Fi2-M12-CP6L-Q12	2mm	Flush	PNP NC	10...30VDC	≤200mA	1000Hz	-25...70°C	M12 Connector	Fig.1
Fi2-M12-CN6L-Q12	2mm	Flush	NPN NC	10...30VDC	≤200mA	1000Hz	-25...70°C	M12 Connector	Fig.1
Ni4-M12-OP6L-Q12	4mm	Non-flush	PNP NO	10...30VDC	≤200mA	800Hz	-25...70°C	M12 Connector	Fig.2
Ni4-M12-ON6L-Q12	4mm	Non-flush	NPN NO	10...30VDC	≤200mA	800Hz	-25...70°C	M12 Connector	Fig.2
Ni4-M12-CP6L-Q12	4mm	Non-flush	PNP NC	10...30VDC	≤200mA	800Hz	-25...70°C	M12 Connector	Fig.2
Ni4-M12-CN6L-Q12	4mm	Non-flush	NPN NC	10...30VDC	≤200mA	800Hz	-25...70°C	M12 Connector	Fig.2
Ni5-M12-OP6L-Q12	5mm	Non-flush	PNP NO	10...30VDC	≤200mA	800Hz	-25...70°C	M12 Connector	Fig.2
Ni5-M12-ON6L-Q12	5mm	Non-flush	NPN NO	10...30VDC	≤200mA	800Hz	-25...70°C	M12 Connector	Fig.2
Ni5-M12-CP6L-Q12	5mm	Non-flush	PNP NC	10...30VDC	≤200mA	800Hz	-25...70°C	M12 Connector	Fig.2
Ni5-M12-CN6L-Q12	5mm	Non-flush	NPN NC	10...30VDC	≤200mA	800Hz	-25...70°C	M12 Connector	Fig.2

Dimensions:

Fig.1

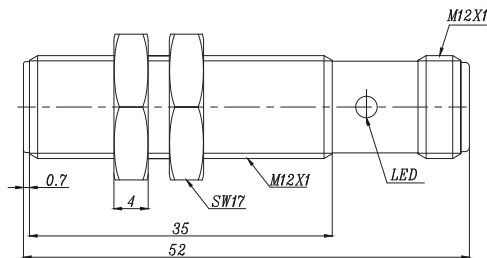
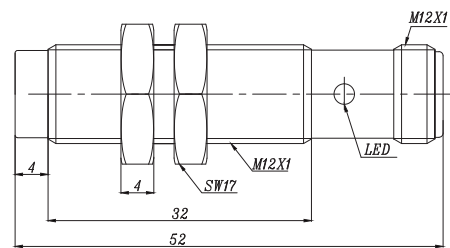

Fig.2



Metal Barrel-M12



Description:

Brass nickel-plated, threaded barrel, DC 4-wire output, IP67 protection class, LED indicator.

Inductive Sensors

Technical Data:

Type	Rated Operating Distance S_n	Mounting	Output	Voltage Range U_B	Rated Current	Switching Frequency	Ambient Temperature	Connection	Fig
Fi2-M12-BP6L	2mm	Flush	PNP NO+NC	10...30VDC	≤ 200 mA	1000Hz	-25...70°C	2m cable	Fig.1
Fi2-M12-BN6L	2mm	Flush	NPN NO+NC	10...30VDC	≤ 200 mA	1000Hz	-25...70°C	2m cable	Fig.1
Ni4-M12-BP6L	4mm	Non-flush	PNP NO+NC	10...30VDC	≤ 200 mA	800Hz	-25...70°C	2m cable	Fig.2
Ni4-M12-BN6L	4mm	Non-flush	NPN NO+NC	10...30VDC	≤ 200 mA	800Hz	-25...70°C	2m cable	Fig.2
Ni5-M12-BP6L	5mm	Non-flush	PNP NO+NC	10...30VDC	≤ 200 mA	800Hz	-25...70°C	2m cable	Fig.2
Ni5-M12-BN6L	5mm	Non-flush	NPN NO+NC	10...30VDC	≤ 200 mA	800Hz	-25...70°C	2m cable	Fig.2
Fi2-M12-BP6L-Q12	2mm	Flush	PNP NO+NC	10...30VDC	≤ 200 mA	1000Hz	-25...70°C	M12 Connector	Fig.3
Fi2-M12-BN6L-Q12	2mm	Flush	NPN NO+NC	10...30VDC	≤ 200 mA	1000Hz	-25...70°C	M12 Connector	Fig.3
Ni4-M12-BP6L-Q12	4mm	Non-flush	PNP NO+NC	10...30VDC	≤ 200 mA	800Hz	-25...70°C	M12 Connector	Fig.4
Ni4-M12-BN6L-Q12	4mm	Non-flush	NPN NO+NC	10...30VDC	≤ 200 mA	800Hz	-25...70°C	M12 Connector	Fig.4
Ni5-M12-BP6L-Q12	5mm	Non-flush	PNP NO+NC	10...30VDC	≤ 200 mA	800Hz	-25...70°C	M12 Connector	Fig.4
Ni5-M12-BN6L-Q12	5mm	Non-flush	NPN NO+NC	10...30VDC	≤ 200 mA	800Hz	-25...70°C	M12 Connector	Fig.4

Dimensions:

Fig.1

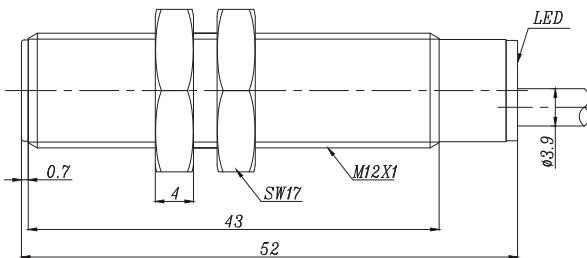

Fig.2

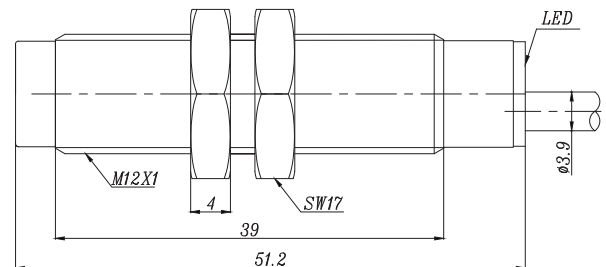

Fig.3

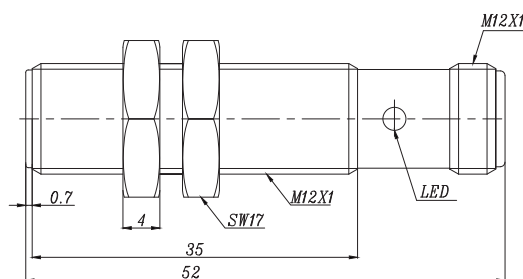
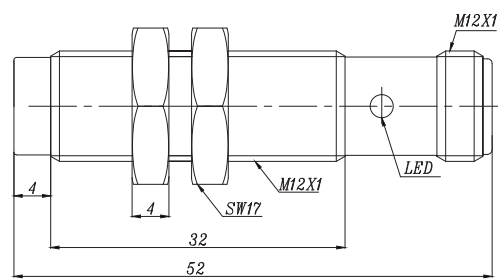

Fig.4



<< Inductive Sensor

Metal Barrel-M12



Description:

Brass nickel-plated, threaded barrel, AC 2-wire output, IP67 protection class, LED indicator.

Technical Data:

Type	Rated Operating Distance S_n	Mounting	Output	Voltage Range U_B	Rated Current	Switching Frequency	Ambient Temperature	Connection	Fig
Fi2-M12-OSA3L	2mm	Flush	AC NO	20...250VAC	$\leq 200\text{mA}$	40Hz	-25...70°C	2m cable	Fig.1
Fi2-M12-CSA3L	2mm	Flush	AC NC	20...250VAC	$\leq 200\text{mA}$	40Hz	-25...70°C	2m cable	Fig.1
Ni4-M12-OSA3L	4mm	Non-flush	AC NO	20...250VAC	$\leq 200\text{mA}$	40Hz	-25...70°C	2m cable	Fig.2
Ni4-M12-CSA3L	4mm	Non-flush	AC NC	20...250VAC	$\leq 200\text{mA}$	40Hz	-25...70°C	2m cable	Fig.2
Fi2-M12-OSA3L-Q12	2mm	Flush	AC NO	20...250VAC	$\leq 200\text{mA}$	40Hz	-25...70°C	M12 Connector	Fig.3
Fi2-M12-CSA3L-Q12	2mm	Flush	AC NC	20...250VAC	$\leq 200\text{mA}$	40Hz	-25...70°C	M12 Connector	Fig.3
Ni4-M12-OSA3L-Q12	4mm	Non-flush	AC NO	20...250VAC	$\leq 200\text{mA}$	40Hz	-25...70°C	M12 Connector	Fig.4
Ni4-M12-CSA3L-Q12	4mm	Non-flush	AC NC	20...250VAC	$\leq 200\text{mA}$	40Hz	-25...70°C	M12 Connector	Fig.4

Dimensions:

Fig.1

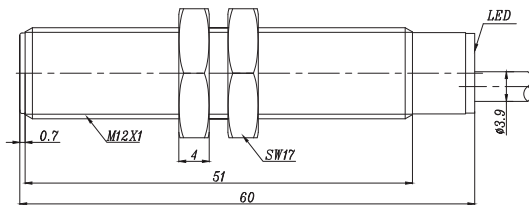

Fig.2

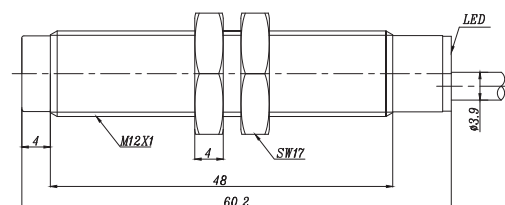

Fig.3

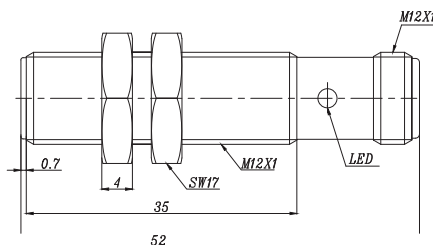
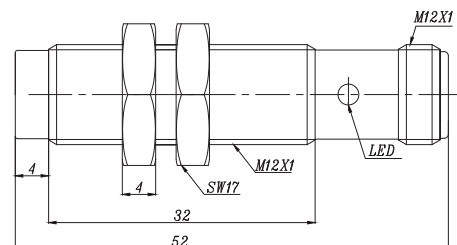

Fig.4



Metal Barrel-M12



Description:

Brass nickel-plated, threaded barrel, AC/DC 2-wire output, IP67 protection class, LED indicator.

Inductive Sensors

Technical Data:

Type	Rated Operating Distance S_n	Mounting	Output	Voltage Range U_B	Rated Current	Switching Frequency	Ambient Temperature	Connection	Fig
FI2-M12-OA41L	2mm	Flush	DC/AC NO	20...250VAC/DC	DC≤100mA/AC≤200mA	40Hz	-25...70°C	2m cable	Fig.1
FI2-M12-CA41L	2mm	Flush	DC/AC NC	20...250VAC/DC	DC≤100mA/AC≤200mA	40Hz	-25...70°C	2m cable	Fig.1
NI4-M12-OA41L	4mm	Non-flush	DC/AC NO	20...250VAC/DC	DC≤100mA/AC≤200mA	40Hz	-25...70°C	2m cable	Fig.2
NI4-M12-CA41L	4mm	Non-flush	DC/AC NC	20...250VAC/DC	DC≤100mA/AC≤200mA	40Hz	-25...70°C	2m cable	Fig.2
FI2-M12-OA41L-Q12	2mm	Flush	DC/AC NO	20...250VAC/DC	DC≤100mA/AC≤200mA	40Hz	-25...70°C	M12 Connector	Fig.3
FI2-M12-CA41L-Q12	2mm	Flush	DC/AC NC	20...250VAC/DC	DC≤100mA/AC≤200mA	40Hz	-25...70°C	M12 Connector	Fig.3
NI4-M12-OA41L-Q12	4mm	Non-flush	DC/AC NO	20...250VAC/DC	DC≤100mA/AC≤200mA	40Hz	-25...70°C	M12 Connector	Fig.4
NI4-M12-CA41L-Q12	4mm	Non-flush	DC/AC NC	20...250VAC/DC	DC≤100mA/AC≤200mA	40Hz	-25...70°C	M12 Connector	Fig.4

Dimensions:

Fig.1

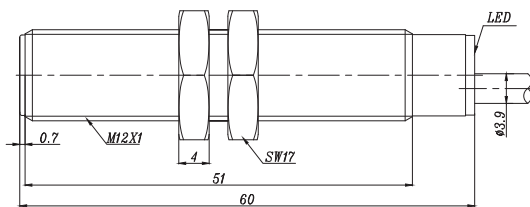

Fig.2

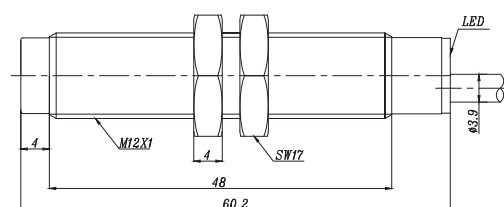

Fig.3

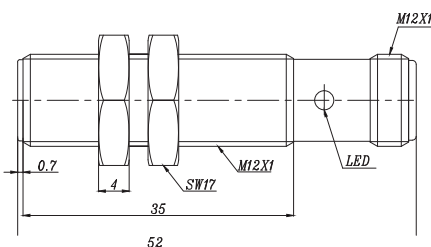
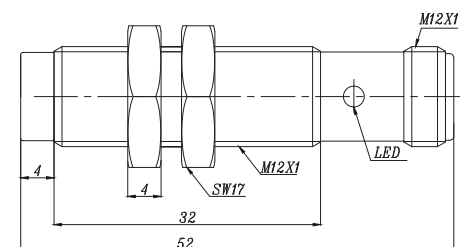

Fig.4



◀◀ Inductive Sensor

Long-Sensing Metal Barrel-M12



Description:

Brass nickel-plated, threaded barrel, extended operating distance, DC 2-wire output, IP67 protection class, LED indicator.

Technical Data:

Type	Rated Operating Distance S_n	Mounting	Output	Voltage Range U_B	Rated Current	Switching Frequency	Ambient Temperature	Connection	Fig
Fi4-M12-OD6L	4mm	Flush	DC NO	10...30VDC	≤100mA	650Hz	-25...70°C	2m cable	Fig.1
Fi4-M12-CD6L	4mm	Flush	DC NC	10...30VDC	≤100mA	650Hz	-25...70°C	2m cable	Fig.1
Ni8-M12-OD6L	8mm	Non-flush	DC NO	10...30VDC	≤100mA	500Hz	-25...70°C	2m cable	Fig.2
Ni8-M12-CD6L	8mm	Non-flush	DC NC	10...30VDC	≤100mA	500Hz	-25...70°C	2m cable	Fig.2
Fi4-M12-OD6L-Q12	4mm	Flush	DC NO	10...30VDC	≤100mA	650Hz	-25...70°C	M12 Connector	Fig.3
Fi4-M12-CD6L-Q12	4mm	Flush	DC NC	10...30VDC	≤100mA	650Hz	-25...70°C	M12 Connector	Fig.3
Ni8-M12-OD6L-Q12	8mm	Non-flush	DC NO	10...30VDC	≤100mA	500Hz	-25...70°C	M12 Connector	Fig.4
Ni8-M12-CD6L-Q12	8mm	Non-flush	DC NC	10...30VDC	≤100mA	500Hz	-25...70°C	M12 Connector	Fig.4

Dimensions:

Fig.1

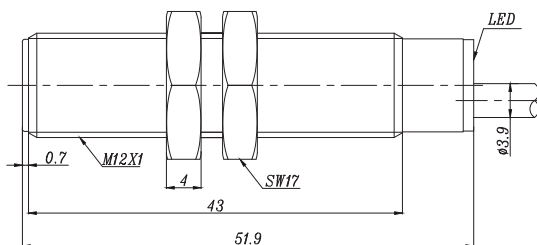

Fig.2

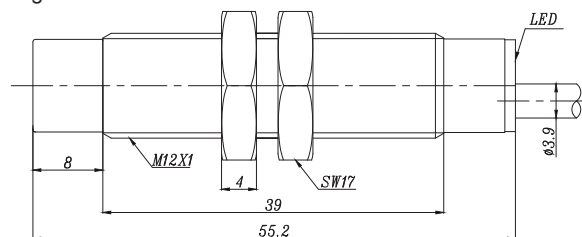

Fig.3

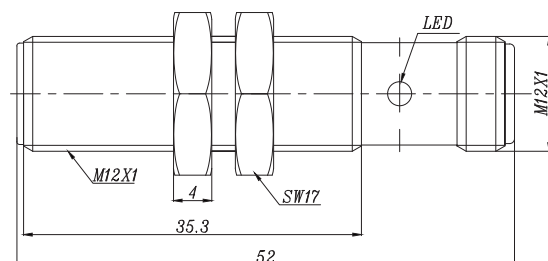
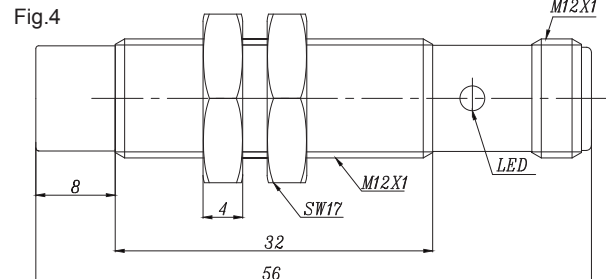

Fig.4



Long-Sensing Metal Barrel-M12



Description:

Brass nickel-plated, threaded barrel, extended operating distance, DC 2-wire output, IP67 protection class, LED indicator.

Inductive Sensors

Technical Data:

Type	Rated Operating Distance Sn	Mounting	Output	Voltage Range U _B	Rated Current	Switching Frequency	Ambient Temperature	Connection	Fig
Fi4-M12-OP6L	4mm	Flush	PNP NO	10...30VDC	≤200mA	650Hz	-25...70°C	2m cable	Fig.1
Fi4-M12-ON6L	4mm	Flush	NPN NO	10...30VDC	≤200mA	650Hz	-25...70°C	2m cable	Fig.1
Fi4-M12-CP6L	4mm	Flush	PNP NC	10...30VDC	≤200mA	650Hz	-25...70°C	2m cable	Fig.1
Fi4-M12-CN6L	4mm	Flush	NPN NC	10...30VDC	≤200mA	650Hz	-25...70°C	2m cable	Fig.1
Ni8-M12-OP6L	8mm	Non-flush	PNP NO	10...30VDC	≤200mA	500Hz	-25...70°C	2m cable	Fig.2
Ni8-M12-ON6L	8mm	Non-flush	NPN NO	10...30VDC	≤200mA	500Hz	-25...70°C	2m cable	Fig.2
Ni8-M12-CP6L	8mm	Non-flush	PNP NC	10...30VDC	≤200mA	500Hz	-25...70°C	2m cable	Fig.2
Ni8-M12-CN6L	8mm	Non-flush	NPN NC	10...30VDC	≤200mA	500Hz	-25...70°C	2m cable	Fig.2
Fi4-M12-OP6L-Q12	4mm	Flush	PNP NO	10...30VDC	≤200mA	650Hz	-25...70°C	M12 Connector	Fig.3
Fi4-M12-ON6L-Q12	4mm	Flush	NPN NO	10...30VDC	≤200mA	650Hz	-25...70°C	M12 Connector	Fig.3
Fi4-M12-CP6L-Q12	4mm	Flush	PNP NC	10...30VDC	≤200mA	650Hz	-25...70°C	M12 Connector	Fig.3
Fi4-M12-CN6L-Q12	4mm	Flush	NPN NC	10...30VDC	≤200mA	650Hz	-25...70°C	M12 Connector	Fig.3
Ni8-M12-OP6L-Q12	8mm	Non-flush	PNP NO	10...30VDC	≤200mA	500Hz	-25...70°C	M12 Connector	Fig.4
Ni8-M12-ON6L-Q12	8mm	Non-flush	NPN NO	10...30VDC	≤200mA	500Hz	-25...70°C	M12 Connector	Fig.4
Ni8-M12-CP6L-Q12	8mm	Non-flush	PNP NC	10...30VDC	≤200mA	500Hz	-25...70°C	M12 Connector	Fig.4
Ni8-M12-CN6L-Q12	8mm	Non-flush	NPN NC	10...30VDC	≤200mA	500Hz	-25...70°C	M12 Connector	Fig.4

Dimensions:

Fig.1

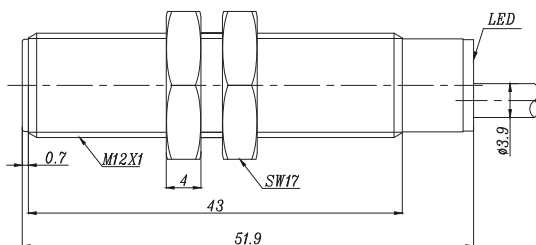

Fig.2

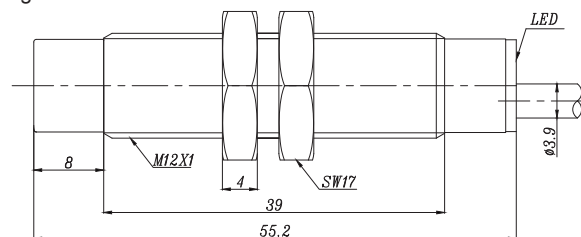

Fig.3

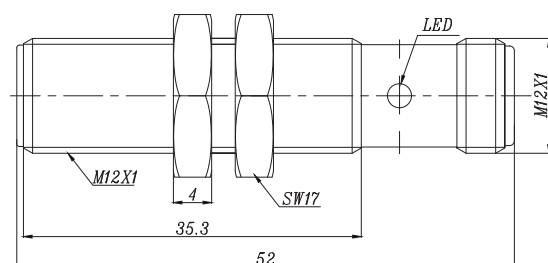
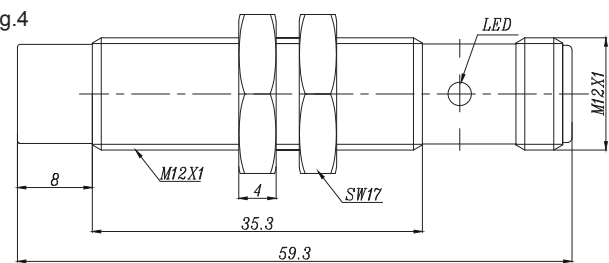

Fig.4



<< Inductive Sensor

Long-Sensing Metal Barrel-M12



Description:

Brass nickel-plated, threaded barrel, extended operating distance, DC 4-wire output, IP67 protection class, LED indicator.

Technical Data:

Type	Rated Operating Distance Sn	Mounting	Output	Voltage Range U_B	Rated Current	Switching Frequency	Ambient Temperature	Connection	Fig
Fi4-M12-BP6L	4mm	Flush	NO+NC PNP	10...30VDC	≤200mA	650Hz	-25...70°C	2m cable	Fig.1
Fi4-M12-BN6L	4mm	Flush	NO+NC NPN	10...30VDC	≤200mA	650Hz	-25...70°C	2m cable	Fig.1
Ni8-M12-BP6L	8mm	Non-flush	NO+NC PNP	10...30VDC	≤200mA	500Hz	-25...70°C	2m cable	Fig.2
Ni8-M12-BN6L	8mm	Non-flush	NO+NC NPN	10...30VDC	≤200mA	500Hz	-25...70°C	2m cable	Fig.2
Fi4-M12-BP6L-Q12	4mm	Flush	NO+NC PNP	10...30VDC	≤200mA	650Hz	-25...70°C	M12 Connector	Fig.3
Fi4-M12-BN6L-Q12	4mm	Flush	NO+NC NPN	10...30VDC	≤200mA	650Hz	-25...70°C	M12 Connector	Fig.3
Ni8-M12-BP6L-Q12	8mm	Non-flush	NO+NC PNP	10...30VDC	≤200mA	500Hz	-25...70°C	M12 Connector	Fig.4
Ni8-M12-BN6L-Q12	8mm	Non-flush	NO+NC NPN	10...30VDC	≤200mA	500Hz	-25...70°C	M12 Connector	Fig.4

Dimensions:

Fig.1

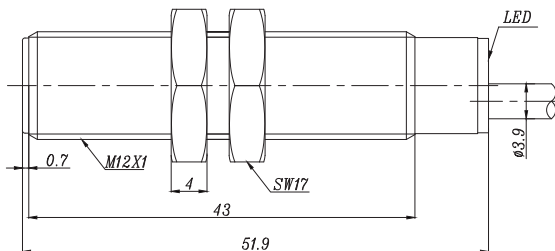

Fig.2

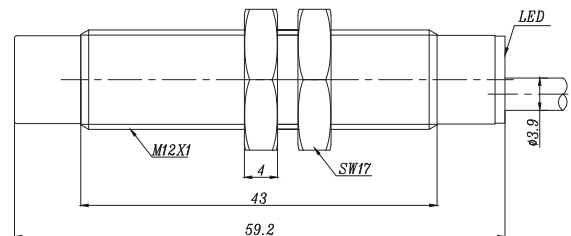

Fig.3

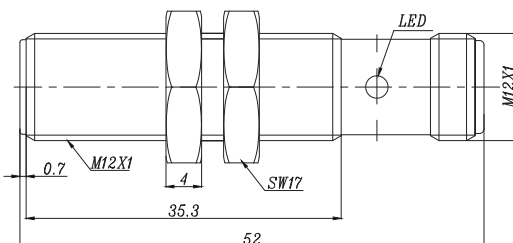
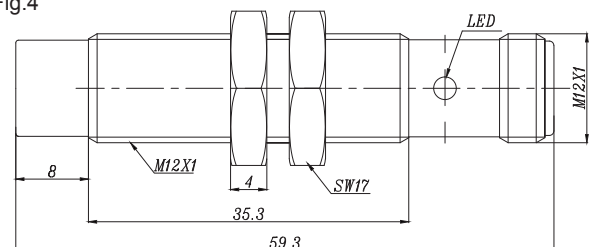

Fig.4



Long-Sensing Metal Barrel-M12



Description:

Brass nickel-plated, threaded barrel, extended operating distance, AC 2-wire output, IP67 protection class, LED indicator.

Inductive Sensors

Technical Data:

Type	Rated Operating Distance S _n	Mounting	Output	Voltage Range U _B	Rated Current	Switching Frequency	Ambient Temperature	Connection	Fig
Fi4-M12-OSA3L	4mm	Flush	NO AC	20...250VAC	≤200mA	40Hz	-25...70°C	2m cable	Fig.1
Fi4-M12-CSA3L	4mm	Flush	NC AC	20...250VAC	≤200mA	40Hz	-25...70°C	2m cable	Fig.1
Ni8-M12-OSA3L	8mm	Non-flush	NO AC	20...250VAC	≤200mA	40Hz	-25...70°C	2m cable	Fig.2
Ni8-M12-CSA3L	8mm	Non-flush	NC AC	20...250VAC	≤200mA	40Hz	-25...70°C	2m cable	Fig.2
Fi4-M12-OSA3L-Q12	4mm	Flush	NO AC	20...250VAC	≤200mA	40Hz	-25...70°C	M12 Connector	Fig.3
Fi4-M12-CSA3L-Q12	4mm	Flush	NC AC	20...250VAC	≤200mA	40Hz	-25...70°C	M12 Connector	Fig.3
Ni8-M12-OSA3L-Q12	8mm	Non-flush	NO AC	20...250VAC	≤200mA	40Hz	-25...70°C	M12 Connector	Fig.4
Ni8-M12-CSA3L-Q12	8mm	Non-flush	NC AC	20...250VAC	≤200mA	40Hz	-25...70°C	M12 Connector	Fig.4

Dimensions:

Fig.1

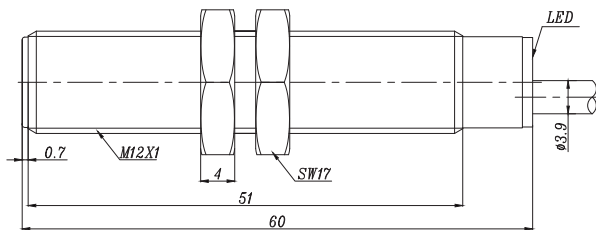

Fig.2

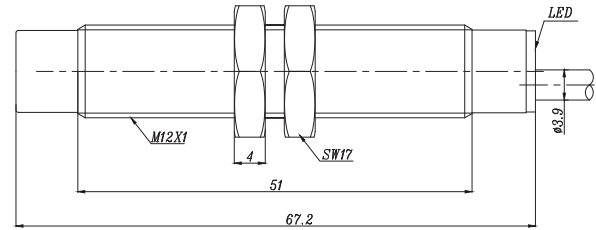

Fig.3

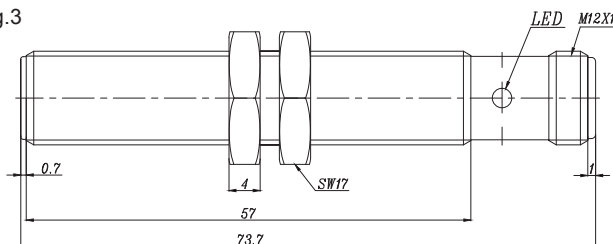
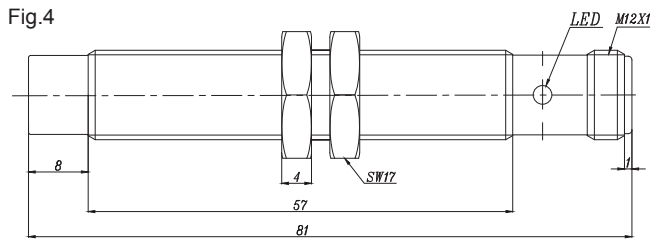

Fig.4



<< Inductive Sensor

Long-Sensing Metal Barrel-M12



Description:

Brass nickel-plated, threaded barrel, extended operating distance, AC/DC 2-wire output, IP67 protection class, LED indicator.

Technical Data:

Type	Rated Operating Distance Sn	Mounting	Output	Voltage Range U _B	Rated Current	Switching Frequency	Ambient Temperature	Connection	Fig
Fi4-M12-OA41L	4mm	Flush	NO DC/AC	20...250VAC/DC	DC≤100mA/AC≤200mA	20/650Hz	-25...70°C	2m cable	Fig.1
Fi4-M12-CA41L	4mm	Flush	NC DC/AC	20...250VAC/DC	DC≤100mA/AC≤200mA	20/650Hz	-25...70°C	2m cable	Fig.1
Ni8-M12-OA41L	8mm	Non-flush	NO DC/AC	20...250VAC/DC	DC≤100mA/AC≤200mA	20/500Hz	-25...70°C	2m cable	Fig.2
Ni8-M12-CA41L	8mm	Non-flush	NC DC/AC	20...250VAC/DC	DC≤100mA/AC≤200mA	20/500Hz	-25...70°C	2m cable	Fig.2
Fi4-M12-OA41L-Q12	4mm	Flush	NO DC/AC	20...250VAC/DC	DC≤100mA/AC≤200mA	20/650Hz	-25...70°C	M12 Connector	Fig.3
Fi4-M12-CA41L-Q12	4mm	Flush	NC DC/AC	20...250VAC/DC	DC≤100mA/AC≤200mA	20/650Hz	-25...70°C	M12 Connector	Fig.3
Ni8-M12-OA41L-Q12	8mm	Non-flush	NO DC/AC	20...250VAC/DC	DC≤100mA/AC≤200mA	20/500Hz	-25...70°C	M12 Connector	Fig.4
Ni8-M12-CA41L-Q12	8mm	Non-flush	NC DC/AC	20...250VAC/DC	DC≤100mA/AC≤200mA	20/500Hz	-25...70°C	M12 Connector	Fig.4

Dimensions:

Fig.1

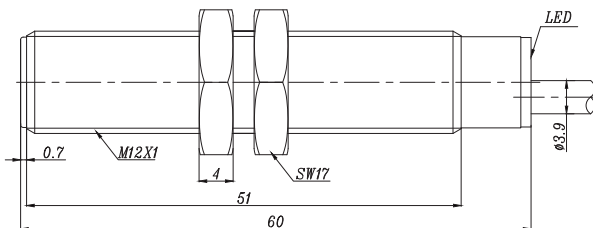

Fig.2

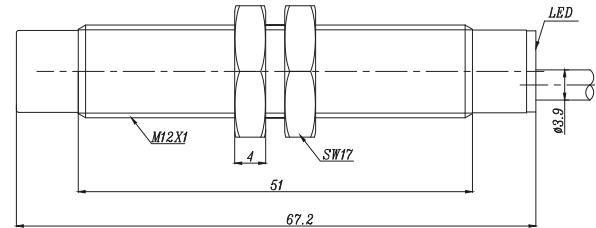

Fig.3

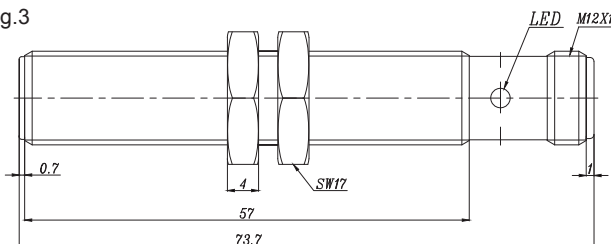

Fig.4

